

MD 520 304/MD 520 404

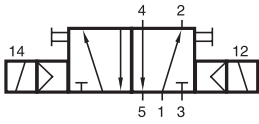

MD 520 304
MD 520 404

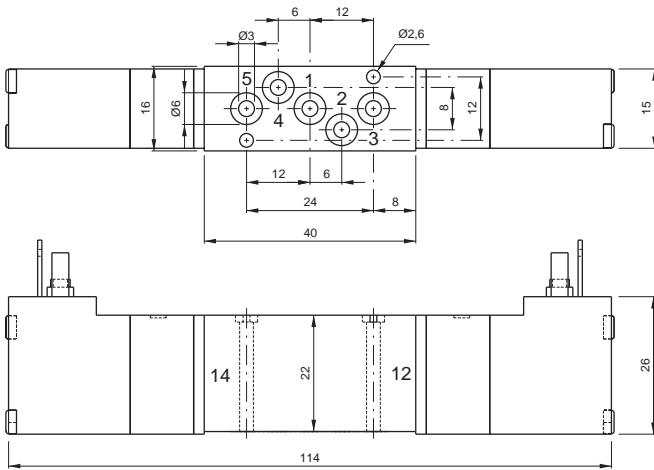
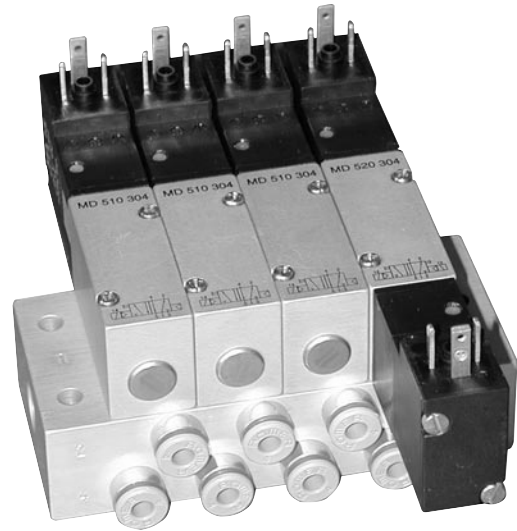

5/2-way double solenoid valve, actuated by impulse. Position is kept until an electrical signal is applied to the opposite side, even when not attached to electrical source. All the ports are in the plate.

Available with solenoid operators 24 V = or 230 V ~.

Valves are generally equipped with manual override to push.

Manifolds are displayed on page 2.6.2.4.

Blanking plates are also available; type BP 5 304 or BP 5 404.

Mounting screws and seals are included.

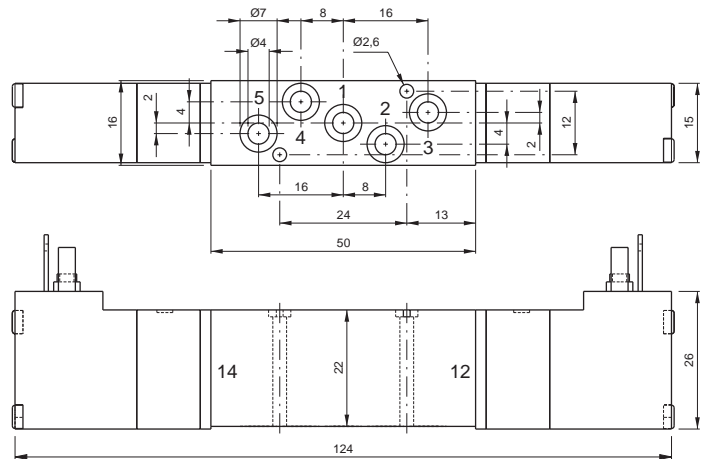

Type	Width [mm]	Port size 1 to 5	Air flow [l/min]	Operating pressure	Power consumption
MD 520 304	16	drilling 3,0	280	3-10 bar	1.9 W / 3.6 VA
MD 520 404	16	drilling 4,0	450	3-10 bar	1.9 W / 3.6 VA

2.5.2.2.11.