

MD 310 403  
MD 310 463

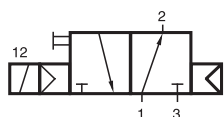

MOD 310 403  
MOD 310 463

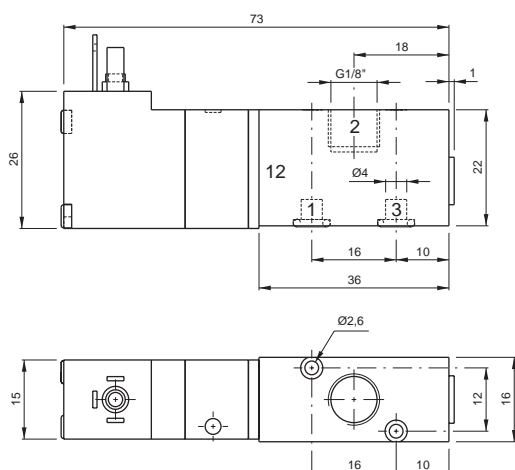
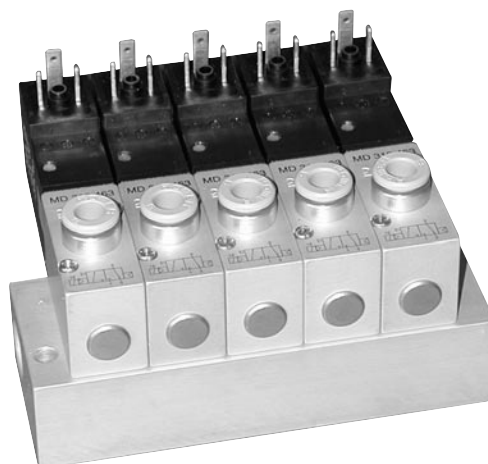

3/2-way solenoid valve, normally closed (MD) or normally open (MOD), for assembling on a manifold plate, with push-in fitting or with thread G 1/8" at port 2.

Available with solenoid operators 24 V = or 230 V ~.

Valves are generally equipped with manual override to push

Manifolds are displayed on page 2.6.1.1.

Valves normally open and normally closed can be mixed on one manifold plate!

Blanking plates are also available: Type no. BP 3 403.

Mounting screws and seals are included.

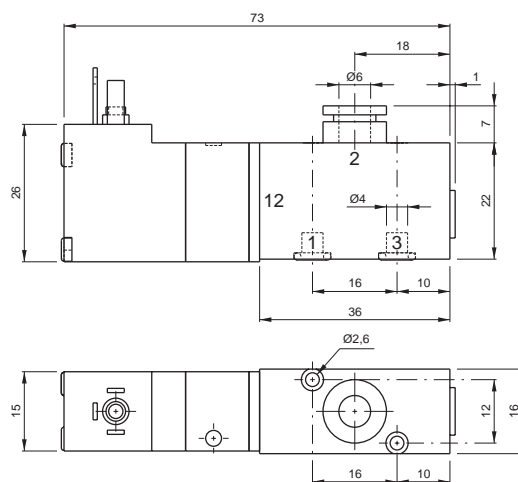

Type	Function	Width [mm]	Port size 2	Air flow [l/min]	Operating pressure	Power consumption
MD 310 403	n.c.	16	G 1/8"	450	3-10 bar	1.9 W / 3.6 VA
MD 310 463	n.c.	16	6 mm p.i.f.	450	3-10 bar	1.9 W / 3.6 VA
MOD 310 403	n.o.	16	G 1/8"	450	3-10 bar	1.9 W / 3.6 VA
MOD 310 463	n.o.	16	6 mm p.i.f.	450	3-10 bar	1.9 W / 3.6 VA