

MD 310 343/MOD 310 343

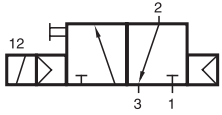

MD 310 343

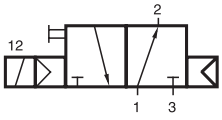

MOD 310 343

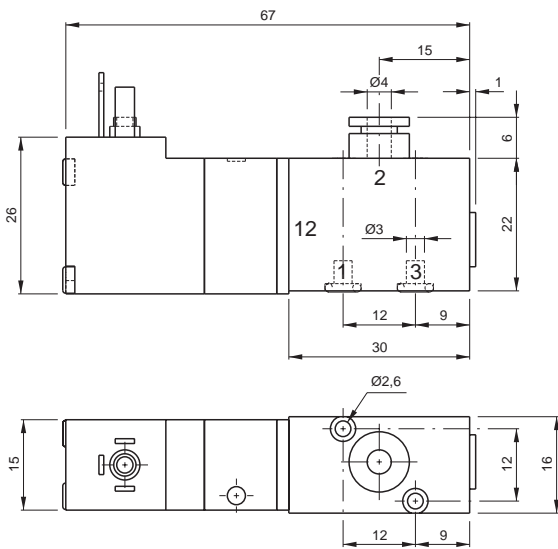
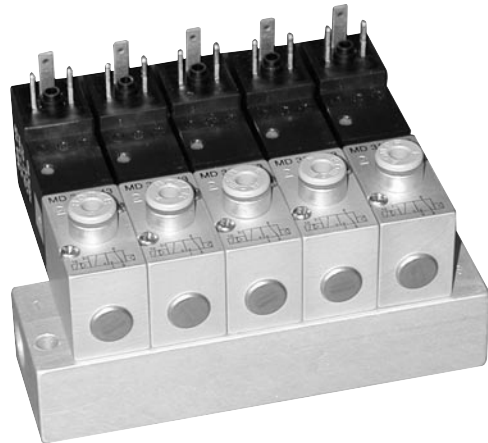

3/2-way solenoid valve, normally closed (MD) or normally open (MOD), for assembling on a manifold plate, with push-in fitting at port 2.

Available with solenoid operators 24 V = or 230 V ~.

Valves are generally equipped with manual override to push.

Manifolds are displayed on page 2.6.1.1.

Valves normally open and normally closed can be mixed on one manifold plate!

Blanking plates are also available: Type no. BP 3 303.

Mounting screws and seals are included.

Type	Function	Width [mm]	Port size	Air flow [l/min]	Operating pressure	Power consumption
MD 310 343	n.c.	16	4 mm p.i.f	280	3-10 bar	1.9 W / 3.6 VA
MOD 310 343	n.o.	16	4 mm p.i.f.	280	3-10 bar	1.9 W / 3.6 VA

2.5.1.2.3.