

MD 310 301/MOD 310 301/MD 310 341/MOD 310 341

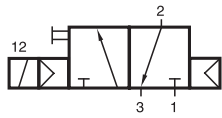

MD 310 301
MD 310 341

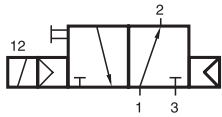

MOD 310 301
MOD 310 341

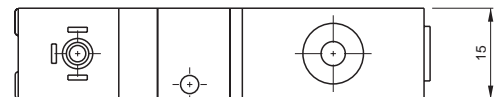
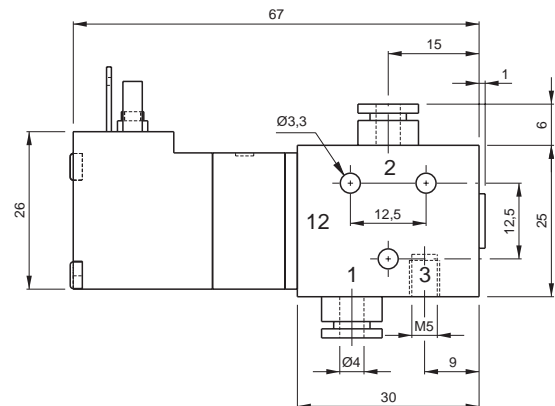
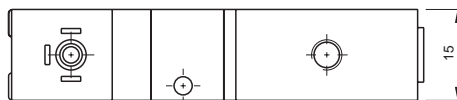
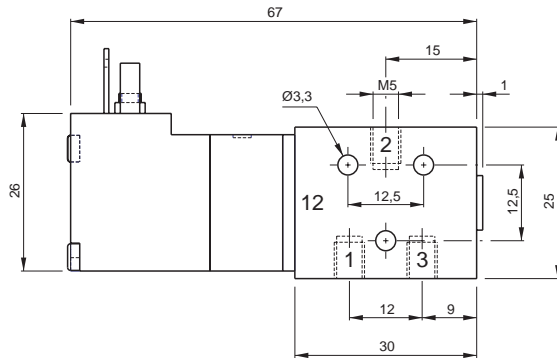
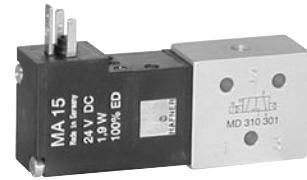

3/2-way solenoid valve normally closed (MD) or normally open (MOD), with air spring, actuated by permanent signal.

Available with solenoid operators 24 V = or 230 V ~.

Valves are generally equipped with manual override to push.

Type	Function	Width [mm]	Port size 1 and 2	Air flow [l/min]	Operating pressure	Power consumption
MD 310 301	n.c.	15	M5	280	3-10 bar	1.9 W / 3.6 VA
MD 310 341	n.c.	15	4 mm p.i.f.	280	3-10 bar	1.9 W / 3.6 VA
MOD 310 301	n.o.	15	M5	280	3-10 bar	1.9 W / 3.6 VA
MOD 310 341	n.o.	15	4 mm p.i.f.	280	3-10 bar	1.9 W / 3.6 VA