

P 520 701
P 520 101

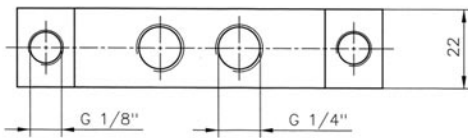
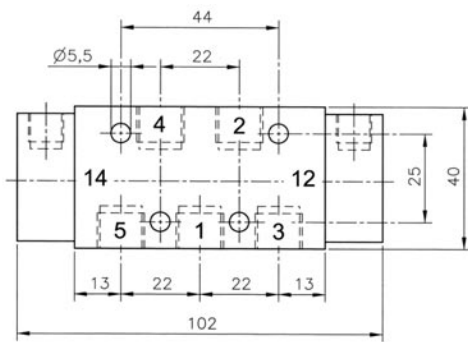
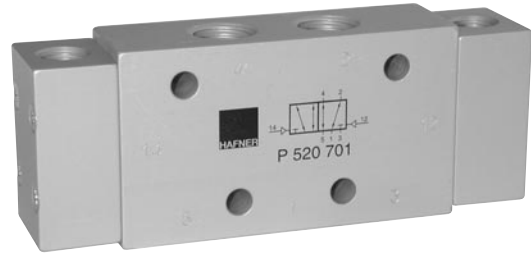

Pneumatically actuated 5/2-way spool valve actuated by impulse. If pressure is applied to 14, the valve is open from 1 to 4 and 2 to 3, 5 is closed.

If pressure is applied to 12, the valve is open from 1 to 2 and 4 to 5.

Position is kept until next pneumatical signal is applied.

Exhaust can be throttled.

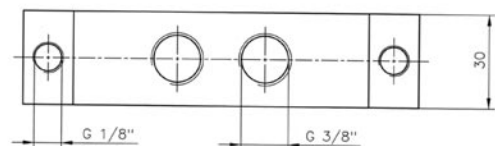
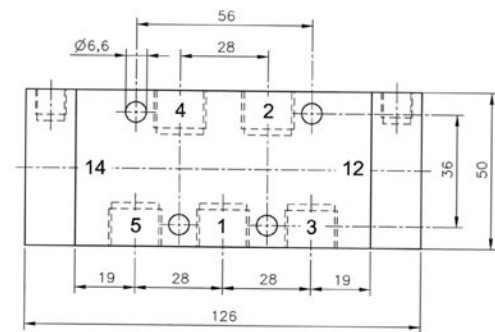

Type	Port size	Air flow	Operating press.	Actuation press.	Weight
P 520 701	G 1/4"	1250 l/min	2 - 10 bar	2,5 - 10 bar	0,18 kg
P 520 101	G 3/8"	2250 l/min	1,5 - 10 bar	2,5 - 10 bar	0,41 kg