

P 520 302  
P 520 502

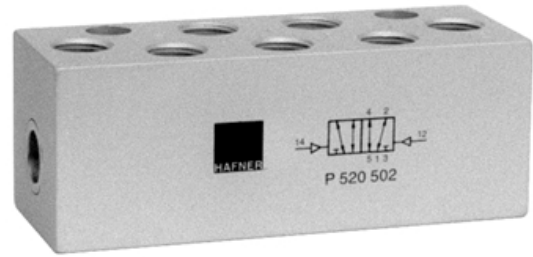

Pneumatically actuated 5/2-way spool valve actuated by impulse at the ports 12 and 14.

Position is kept until next pneumatical signal is applied.

This valve can be equipped with manual override.

Exhaust can be throttled.

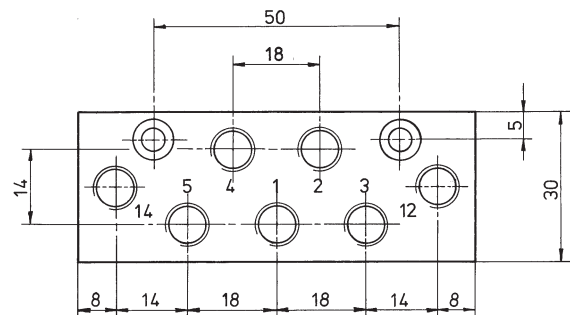
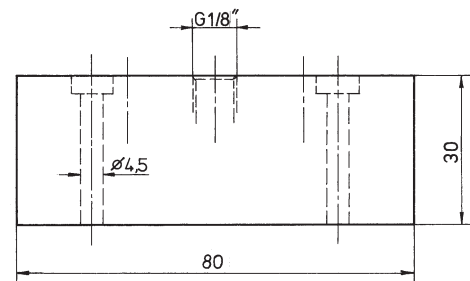
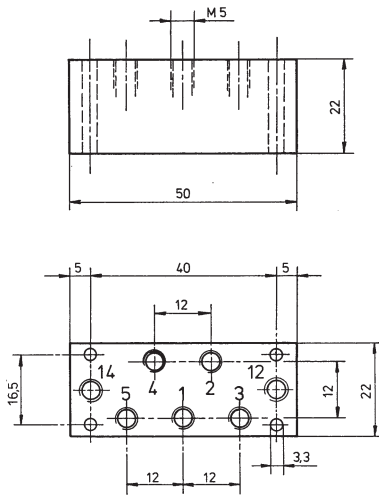

Type	Port size	Air flow	Operating press.	Actuation press.	Weight
P 520 302	M 5	180 l/min	1 - 10 bar	2,5 - 10 bar	0,07 kg
P 520 502	G 1/8"	650 l/min	1 - 10 bar	2,5 - 10 bar	0,17 kg