

P 510 501/P 510 801/P 510 121

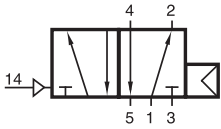

P 510 501
P 510 801
P 510 121

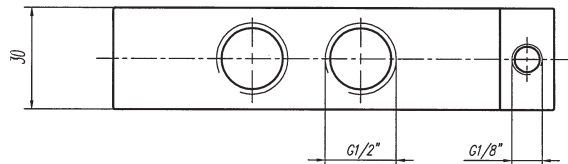
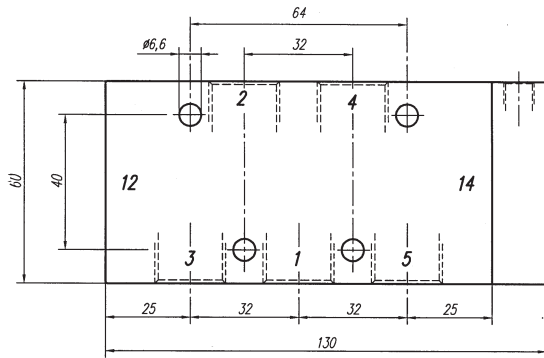
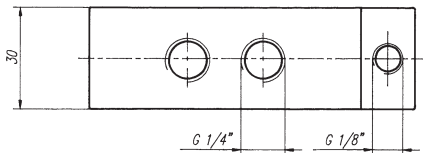
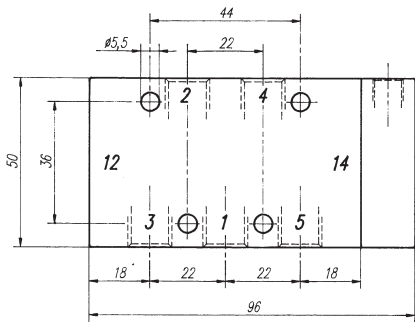
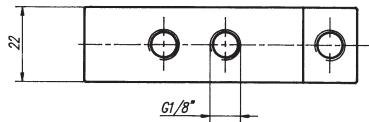
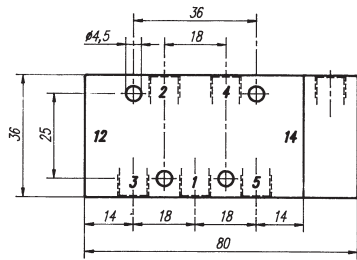
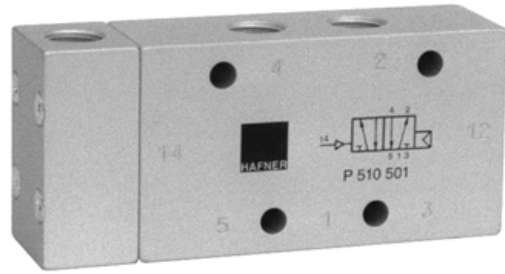

Pneumatically actuated 5/2-way spool valve with air-spring, actuated by permanent signal.

Normally open from 1 to 2 and from 4 to 5. If pressure is applied at 14, the valve is open from 1 to 4 and 2 to 3.

Exhaust can be throttled.

Operating pressure and actuation pressure should be at the same level.

Type	Port size	Air flow	Operating press.	Actuation press.	Weight
P 510 501	G 1/8"	650 l/min	2 - 10 bar	the same	0,16 kg
P 510 801	G 1/4"	1450 l/min	1,5 - 10 bar	the same	0,37 kg
P 510 121	G 1/2"	3000 l/min	1 - 10 bar	the same	0,57 kg

2.4.2.2.