

P 320 302/P 320 502

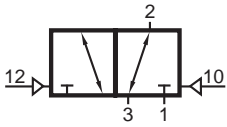

P 320 302
P 320 502

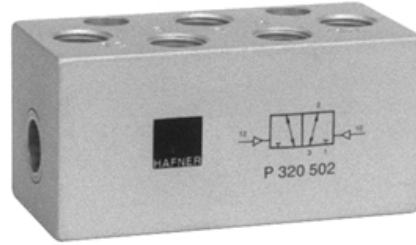

Pneumatically actuated 3/2-way spool valve actuated by impulse.

If pressure is applied at 12, the valve is open from 1 to 2; if pressure is applied at 10, the valve is open from 2 to 3.

Position is kept until next pneumatical signal is applied.

This valve can be equipped with manual override.

Exhaust can be throttled.

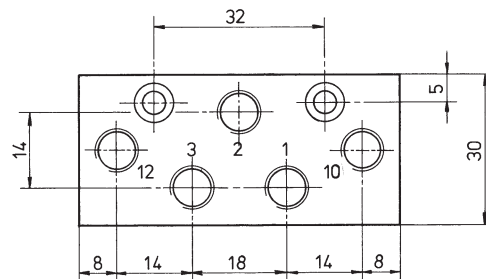
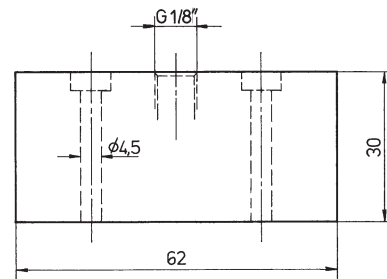
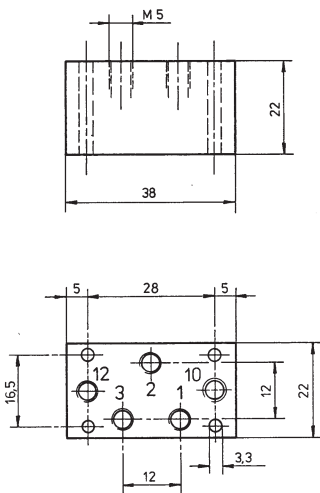

Type	Port size	Air flow	Operating press.	Actuation press.	Weight
P 320 302	M 5	180 l/min	1 - 10 bar	2,5 - 10 bar	0,06 kg
P 320 502	G 1/8"	650 l/min	1 - 10 bar	2,5 - 10 bar	0,14 kg

2.4.1.5.