

BV 511 201

BR 511 201

BL 511 201

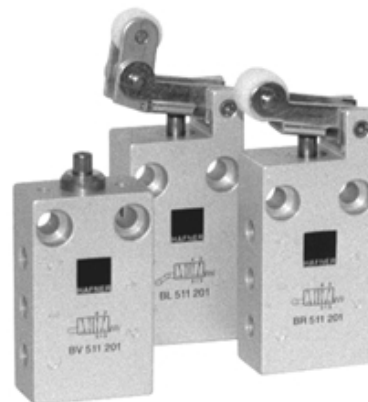

Mechanically actuated 5/2-way spool valve with mechanical spring.

Normally open from 1 to 2 and from 4 to 5. Operated open from 1 to 4 and 2 to 3.

Exhaust can be throttled.

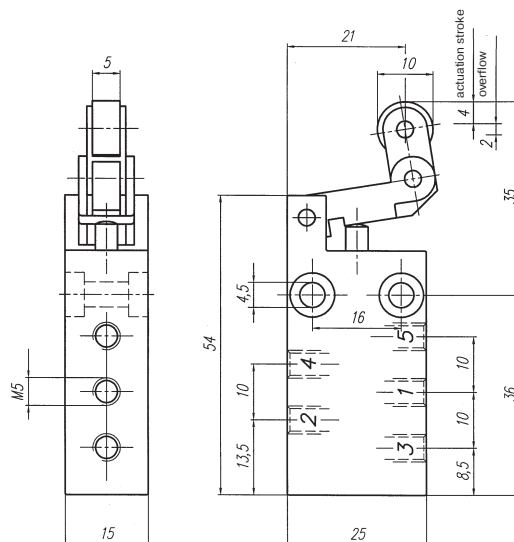
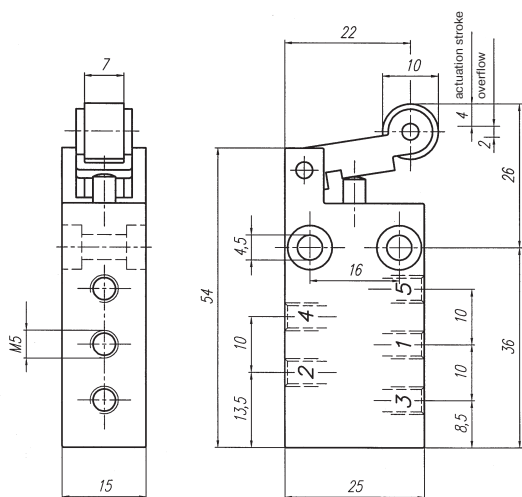
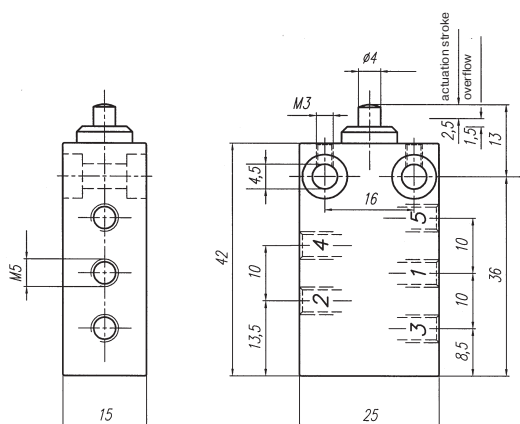

Type	Port size	Air flow	Operating press.	Actuating force	Weight
BV 511 201	M 5	125 l/min	0 - 10 bar	14 N	0,043 kg
BR 511 201	M 5	125 l/min	0 - 10 bar	9 N	0,051 kg
BL 511 201	M 5	125 l/min	0 - 10 bar	9 N	0,054 kg